

Fire Rated Concealed Adjustable Hinge For Invisible Doors - Tested To FD30 / FD60 - 160mm x 32mm - Polished Nickel

Product Images

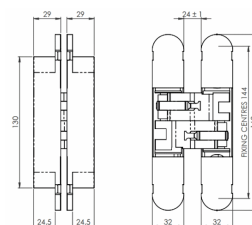

Description

- 160mm x 32mm fire rated* adjustable concealed door hinge
- Fire rated* - suitable for use on FD30 and FD60 fire doors * **when used with the 43426 intumescent kit (see related products) ***
- Polished nickel.
- Minimum door thickness 38mm.
- Ideal for use with fire rated flush doors, where an invisible or hidden door look is required.
 - Cover caps hide the adjustment and fixing screws for an a minimalist look.
 - Totally recessed making the gap between door and frame very small.
 - Easy to install and maintain
- 3D adjustable design (door can be adjusted vertically, horizontally and laterally).
- Opening angle up to 180 (when used with architrave free door frames).

Weight Limits

- Max door weight with 2 x hinges fitted - 80kg
- Max door weight with 3 x hinges fitted (hinges fitted top,middle and bottom) - 120kg
- Max door weight with 3 x hinges fitted (hinges fitted 2 x top,and 1 x bottom) - 140kg

Finish

- Polished nickel.

Dimensions

- 160mm height x 32mm width x 29mm depth.

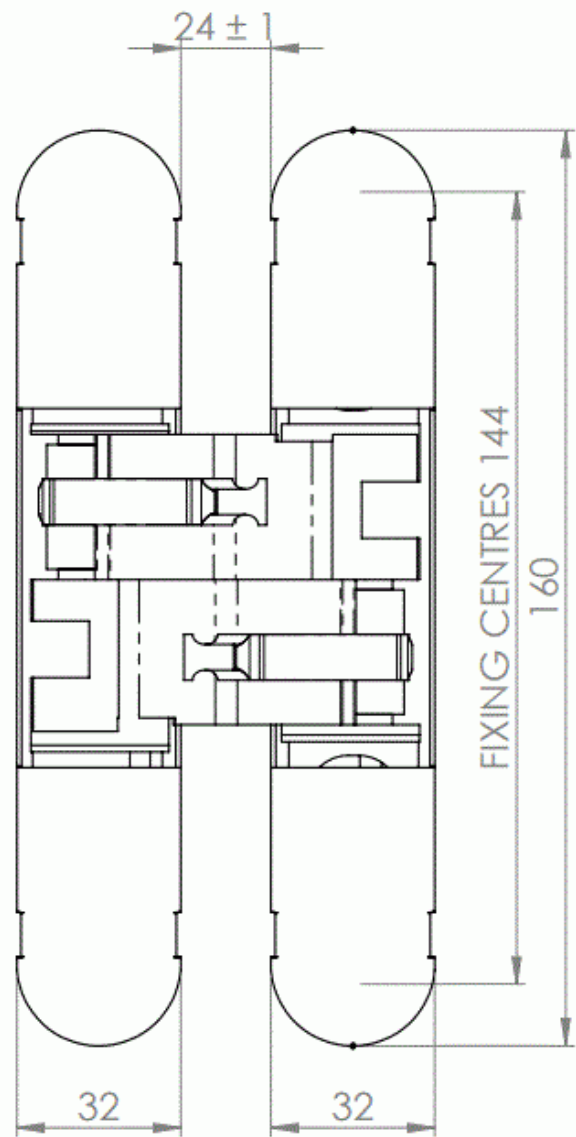
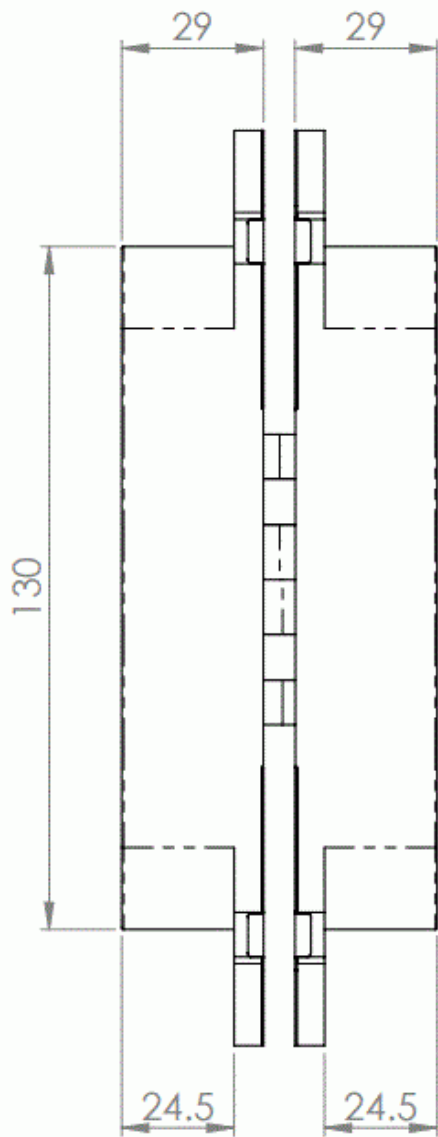

- 3D Adjustable
- +/- 3mm Side
- +/- 3mm Height
- +/- 1.5mm Compression

Installation & Adjustment Videos

Products in this set



43435.1 - Concealed Adjustable Hinge For Invisible Doors - FD30 / FD60 Fire Rated - 160mm x 32mm - Polished Nickel - Each - (1 Hinge)