

---

## Ball Bearing Broad Butt Projection Hinges - 102mm x 102mm - Satin Brass (Lacquered)

### Product Images

---



Description

- Satin brass finish broad butt projection hinges.
- 102mm height x 102mm open width (40mm projection).
- Ideal for double doors.
- Broad butt hinges allow doors to fold back on them self 180 degrees.
- Ball bearing design.
- Suitable for very internal doors.

Finish

- Satin brass.

Dimensions

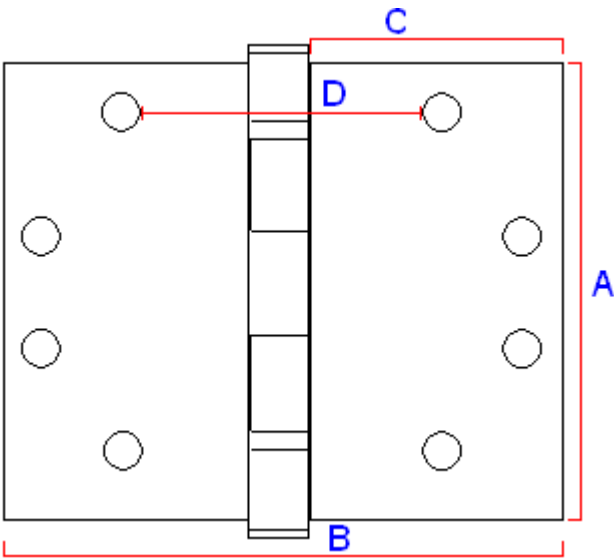

	43446.1	Dimension On Diagram
Height	102mm	A
Width	102mm	B
Leaf Width	43mm	C
Projection given	40mm	D
Thickness	3mm	N/A

Important Info Before You Buy

- Broad butt projection hinges are used to help project or "throw" a door past an obstruction so it can fold back on itself 180 degrees.

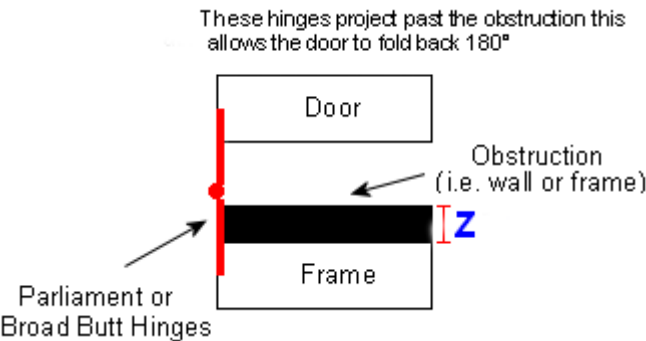
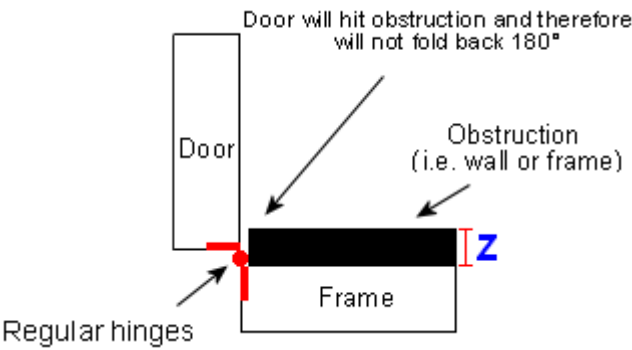

- Suitable for wooden doors
- Base material is brass
- Hinges have 2 ball bearings in the knuckle. This gives the hinge excellent strength / wear-ability on the door and a smooth action
- These hinges have a high quality lacquer coating and are suitable for internal or external use. (Please note the lacquer will break down after time and the brass will tarnish. This will happen a lot quicker on external doors compared to internal doors)
- Hinges are sold and priced in pairs and come supplied with screws

## Products in this set

---



**43446.1 - Ball Bearing Broad Butt Projection Hinges - 102mm x 102mm - Satin Brass (Lacquered) - Pair - (2 Hinges)**