Parliament Projection Hinges 102mm x 102mm - 50mm Projection - Black Nickel

Product Images



Description

- Black nickel finish parliament projection hinges, ideal for double doors.
- Hinges allow doors to fold back on them self through 180 degrees.
- Suitable for medium weight internal and external doors.

Finish

- Black nickel.

Dimensions

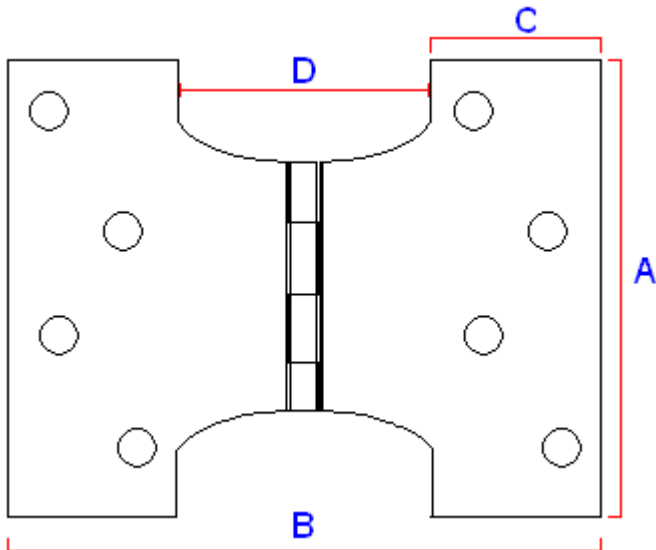

Available in one size only

43475.1 - 102mm x 102mm x 4mm - (50mm Projection)

	43475.1	Dimension On Diagram
Height	102mm	A
Width	102mm	B
Leaf Width	26mm	C
Projection given	50mm	D
Thickness	4mm	N/A

Important Info Before You Buy

- Parliament hinges are used to help project or "throw" a door past an obstruction so it can fold back on itself through 180 degrees

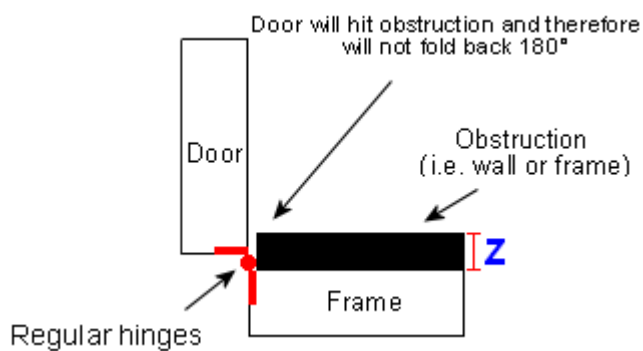

- Suitable for wooden doors.

- Hinges have short knuckle and no washers, therefore only suitable for light - medium weight doors.
- Sold and priced in pairs and come supplied with screws.

Products in this set



43475.1 - Parliament Projection Hinges - 102mm x 102mm x 4mm - (50mm Projection) - Black Nickel - Pair - (2 Hinges)