

Half Set Spindle & Fixing Kit For Bolt Through Door Handles - 8mm x 8mm

Product Images

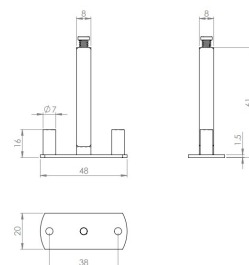

Description

- Half set fixing spindle kit for bolt through door handles.
- Allows a single (half set) of operational door handles to be fitted to one side of the door only, while still utilising the bolt through fixings.
- Suitable for use with round and square rose lever handles with 38mm fixing centres.
- Supplied use with 4mm fixing bolts.
- Designed to pass through the follower of your lock or latch.

Size Details

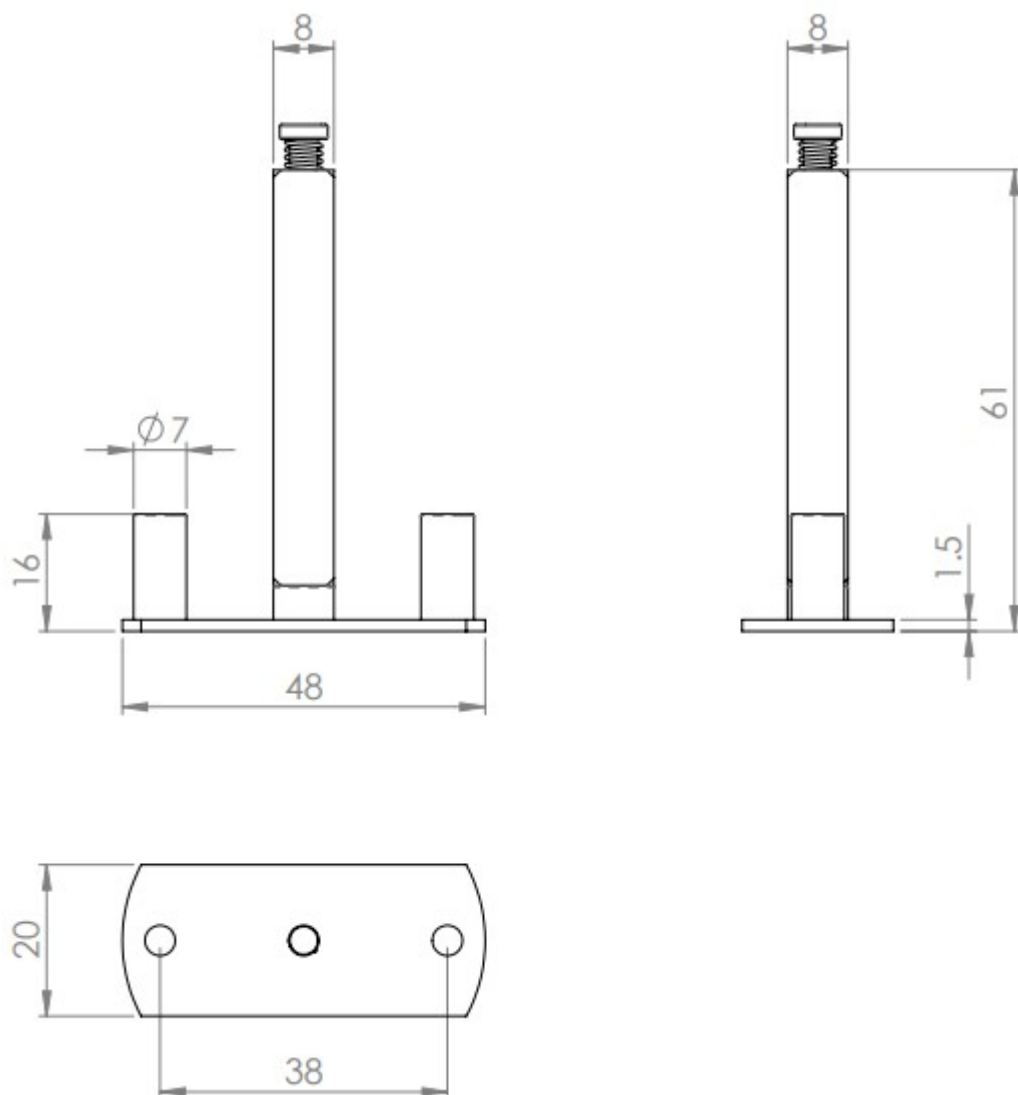

- 8mm x 8mm Spindle
- 61mm Long

Finish Details

- Steel

Unit Of Sale

- This item is sold individually - (Each)

Products in this set



44077.1 - Half Set Fixing Plate For Bolt Through Furniture - 8mm x 8mm - Each