

Oval Shaped Bell Push - 64mm x 30mm - Polished Stainless Steel - Grade 316

Product Images

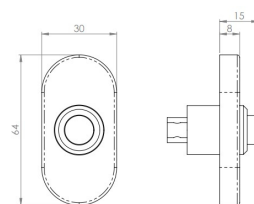

Description

- Architectural quality oval shaped bell push

Finish

- Polished Stainless Steel - Grade 316

Dimensions

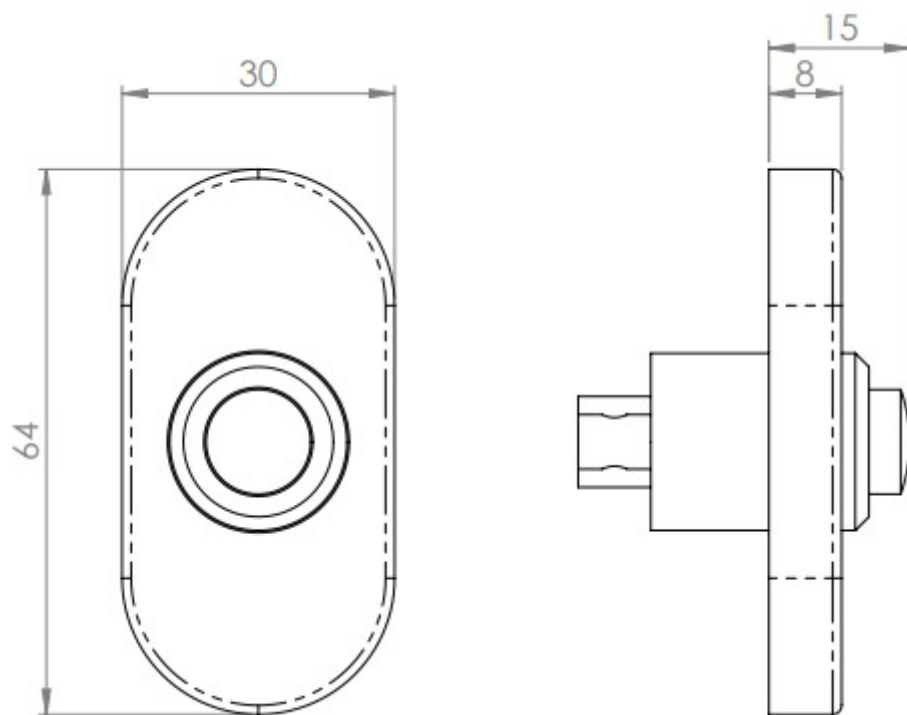

- 64mm x 30mm
- 8mm Depth

Important Info Before You Buy

- Round bell push requires a 22mm diameter drilled a depth of 20mm into wall or frame for the push to sit flush
- Suitable for mains powered (via a transformer) or battery powered systems

Products in this set
