

## Oval Shaped Bell Push - 64mm x 30mm - Satin Stainless Steel - Grade 316

### Product Images

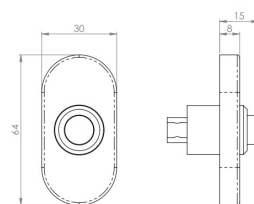

### Description

- Architectural quality oval shaped bell push

#### Finish

- Satin Stainless Steel - Grade 316

#### Dimensions

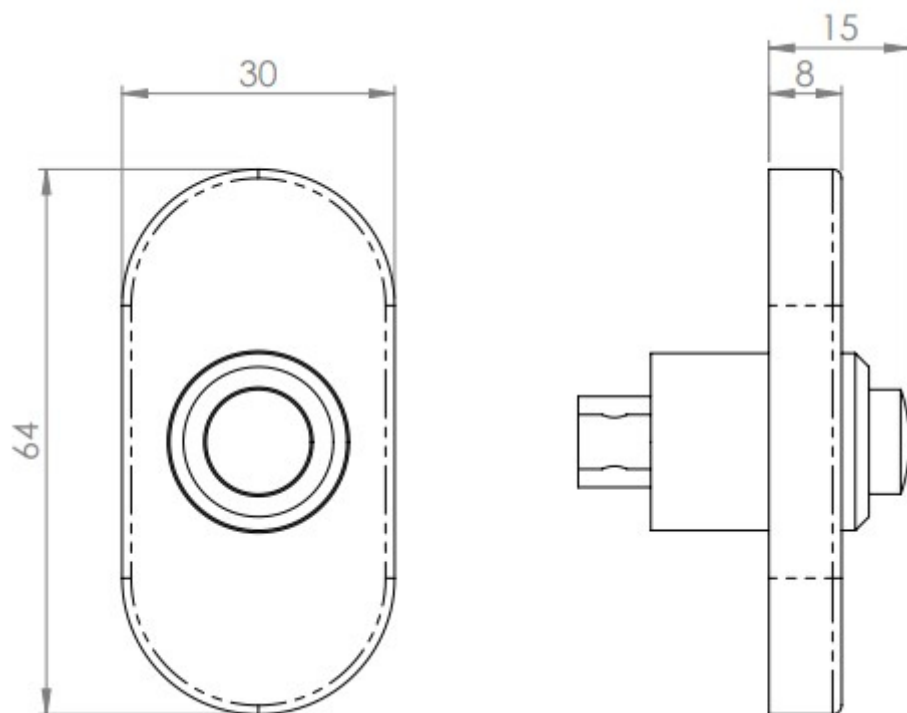

- 64mm x 30mm
- 8mm Depth

#### Important Info Before You Buy

- Round bell push requires a 22mm diameter drilled a depth of 20mm into wall or frame for the push to sit flush
- Suitable for mains powered (via a transformer) or battery powered systems

#### Products in this set



44083.1 - Oval Shaped Bell Push - 64mm x 30mm - Satin Stainless Steel - Grade 316 - Each