Ball Bearing Broad Butt Projection Hinges - 102mm x 102mm - Satin Nickel

Product Images



Description

- Satin nickel finish broad butt projection hinges.
- 102mm height x 102mm open width (40mm projection).
- Ideal for double doors.
- Broad butt hinges allow doors to fold back on them self 180 degrees.
- Ball bearing design.

Finish

- Matt bronze

Dimensions

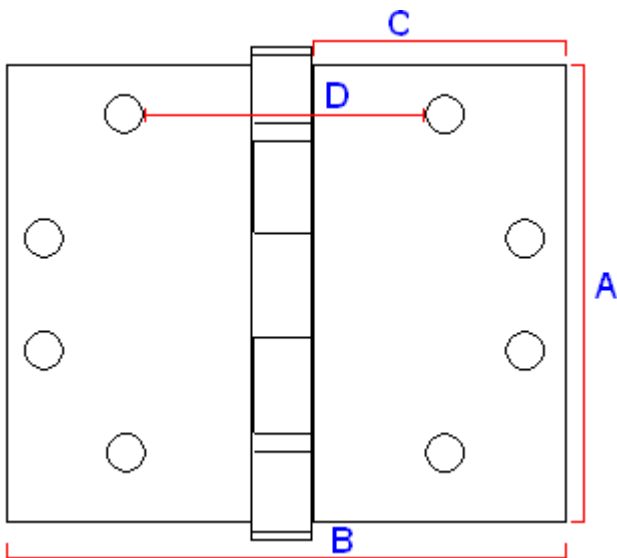

48183.1

Height

102mm

Dimension On Diagram

A

Width

102mm

B

Leaf Width

43mm

C

Projection given

40mm

D

Thickness

3mm

N/A

Important Info Before You Buy

- Broad butt projection hinges are used to help project or "throw" a door past an obstruction so it can fold back on itself 180 degrees.

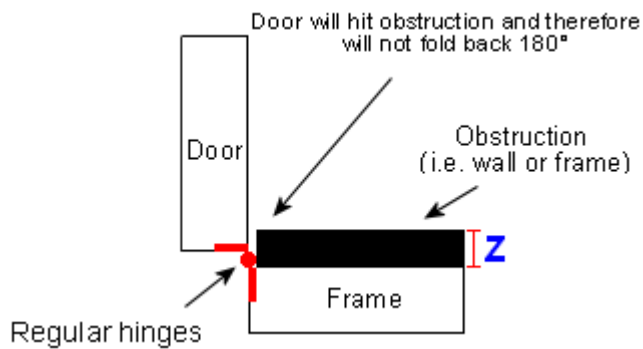

Regular hinges

- Suitable for wooden doors
- Base material is brass
- These hinges have a high quality lacquer coating and are suitable for internal or external use. (Please note the lacquer will break down after time and the brass will tarnish. This will happen a lot quicker on external doors compared to internal doors)
- Hinges are sold and priced in pairs and come supplied with screws



48183.1 - Ball Bearing Broad Butt Projection Hinges - 102mm x 102mm - Satin Nickel - Pair - (2 Hinges)

Products in this set