

Polymer Bearing Grade 13 Hinges - CE / UKCA Marked - Fired Rated - Certifire Approved - 120kg Weight Limit - 102mm x 76mm - Dark Bronze (Powder Coated)

Product Images

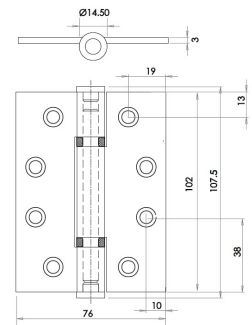

Description

- Grade 13 polymer bearing bronze finish hinges.
- Fire rated, CE Marked / UKCA Marked and Certifire approved
- Tested and passed to British standard EN.1935 2002 overall grade 13.
- Tested to grade 7 door mass suitable for doors up to 120kg in weight.
- The bearing avoid metal to metal movement by using polymer bushes in the knuckle, impregnated with a specially formulated lubricant, This construction eliminates the wear and regular maintenance required by other types of hinge.

Dimensions

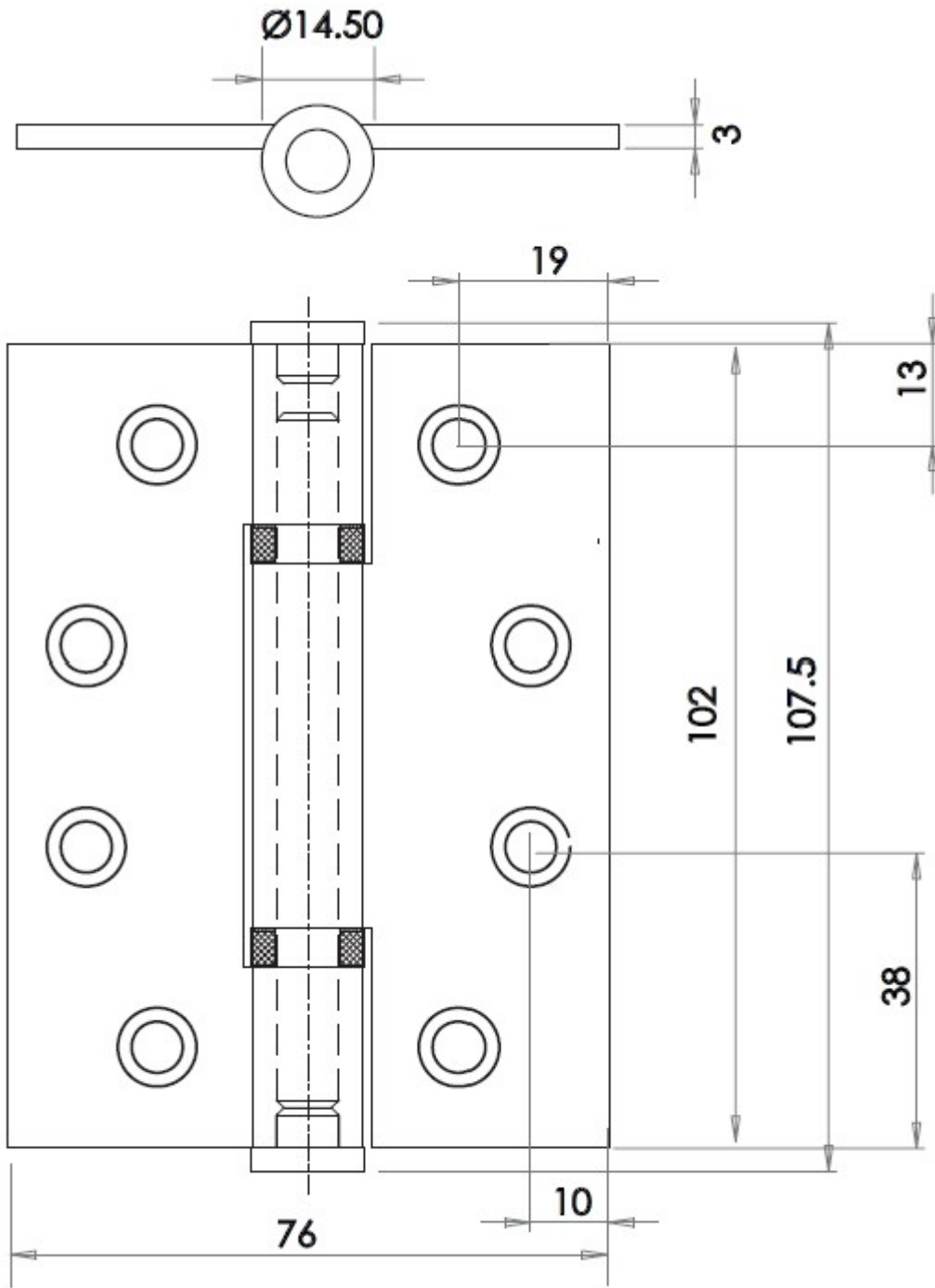

	48339.1	Dimension On Diagram
Height (H)	102mm	A
Width (W)	76mm	B
Leaf Width	30mm	C
Thickness	3mm	N/A

Base Material

- Stainless steel

Finish

- Dark bronze

Standards This Product Conforms To

- Tested and passed to BS EN 1935* the British / European standard requirements and testing methods covering single axis hinges. Classification number - **4-7-7-1-1-4-0-14**.
- ***To meet this standard 2mm thick intumescent liners should be fitted behind each leaf of the hinge.**
- Tested and passed to BS EN 1634 the British / European standard for determining the fire resistance of door and shutter assemblies including hardware. These hinges have been assessed for use on 30 minute and 1 hour timber fire doors FD30 / FD60.
- CE Marked / UKCA Marked
- Certifire approved

Classification Details

- Durability grade 7 - tested to 200,000 opening & closing cycles
- Test door mass grade 7 - suitable for use on doors up to 120kg in weight
- Corrosion resistance grade 4 - high resistance to corrosion in accordance to EN 1670
- Overall hinge grade 13

Usage

- Suitable for use 44mm and 54mm thick wooden doors
- To pass fire regulations three hinges must be fitted per door (pair and a half).

Unit Of Sale

- Sold and priced in **pairs (2 hinges)** supplied with fixing screws.

Products in this set



48339.1 - Polymer Bearing Grade 13 Hinges - CE / UKCA Marked - Fired Rated - Certifire Approved - 120kg Weight Limit - 102mm x 76mm - Dark Bronze (Powder Coated) - Pair