



- Suitable for use on doors between 35mm to 45mm thick

#### Finish

- Satin stainless steel

#### Dimensions

- Lock Case - 70mm deep (50mm backset) mortice hook lock
- Flush Turns - 63mm Diameter x 11mm depth
- Edge Pull - 29mm diameter x 22mm depth
- To Suit Door Thickness - 35mm to 45mm thick

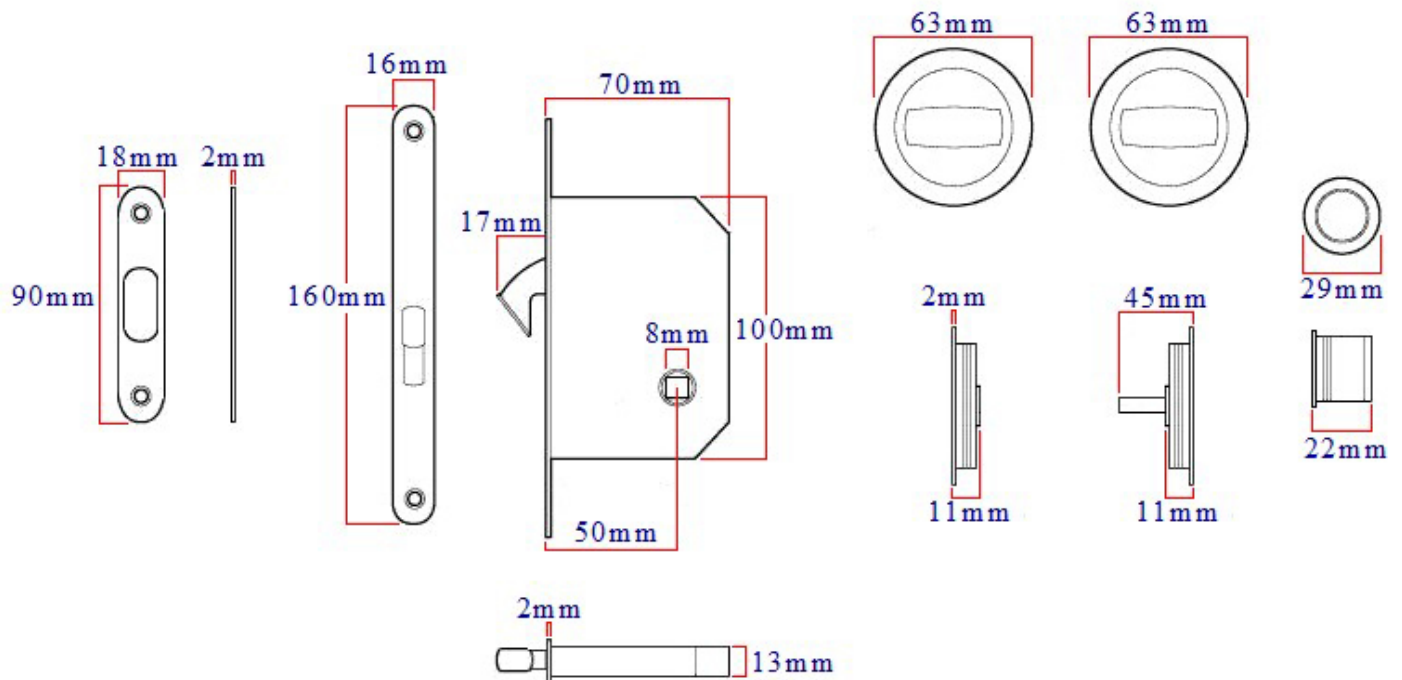

## Unit Of Sale

- Sold per set

#### Products in this set



49129.1 - Circular Turn & Turn Hook Lock For Sliding Pocket Doors - Satin Stainless Steel - Set