Rising Butt Hinges - 102mm x 76mm - Polished Stainless Steel

Product Images



Description

- Architectural quality stainless steel rising butt hinges
- Our rising butt hinges are suitable for internal or external doors that need to self close - (**not** suitable for use on fire doors)

Finish

- Polished stainless steel rising butt hinges

Dimensions

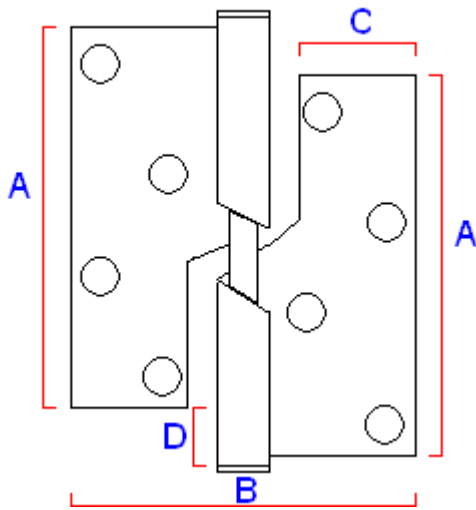

ABOVE DIAGRAM SHOWS A RIGHT HAND RISING BUTT HINGE

Item Code	20154.1	20154.2	Dimension On Diagram
Height	102mm	102mm	A
Width	76mm	76mm	B
Leaf Width	30mm	30mm	C
When door is open at 90degrees rises by	5mm	5mm	D
Thickness	3mm	3mm	N/A

Important Info Before You Buy

- Rising butt hinges are used on doors that need to be self closing but NOT fire rated
- When the door is fully open at 90degrees the door will rise by approximately 5mm
- **Please note - rising butt hinges are handed left or right**
- The below diagram shows how to determine when a LEFT hand rising butt is required

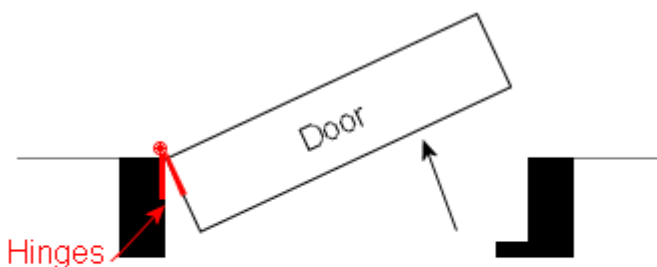

LEFT HAND RISING BUTTS

Stand facing the door

The door must open away from you

With the door hinged on the left

- The below diagram shows how to determine when a RIGHT hand rising butt is required

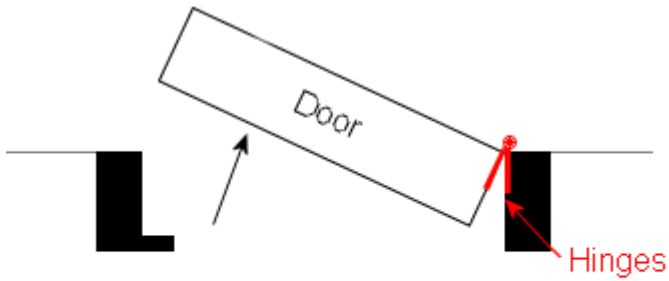

RIGHT HAND RISING BUTTS

Stand facing the door

The door must open away from you
With the door hinged on the right

- Suitable for wooden doors
- Our rising butt hinges base material is stainless steel which is ideal for internal or external use

- Our rising butt hinges are sold and priced in pairs & Come supplied screws

Products in this set



20154.1 - Rising Butt Hinges - Polished Stainless Steel - 102mm x 76mm - Left Hand - Pair



20154.2 - Rising Butt Hinges - Polished Stainless Steel - 102mm x 76mm - Right Hand - Pair