

Ball Bearing Broad Butt Projection Hinges - Grade 13 - Fire Rated - CE / UKCA Marked - Certifire Approved - 120kg Weight Limit - 102mm x 102mm - Matt Antique Brass (Lacquered)

Product Images



Description

- Broad butt projection hinges for double, patio and French doors
- Hinges allow doors to fold back on its self 180 degrees
- Ball bearing design
- One hour fire rated - suitable for use on FD30 and FD60 fire doors.
- Tested and passed to British standard EN.1935 2002 suitable for doors up to 120kg in weight

Finish

- Matt Antique Brass (Lacquered)

Dimensions

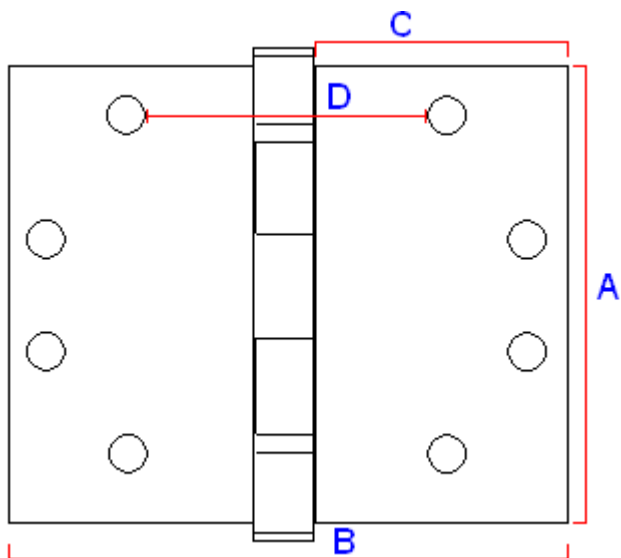

Available in 1 Size only

(102mm x 102mm x 3mm)

20932.1 Dimension On Diagram

Height	102mm	A
Width	102mm	B
Leaf Width	43mm	C
Projection given	50mm	D
Thickness	3mm	N/A

Important Info Before You Buy

- Broad butt projection hinges are used to help project or "throw" a door past an obstruction so it can fold back on its self 180degrees

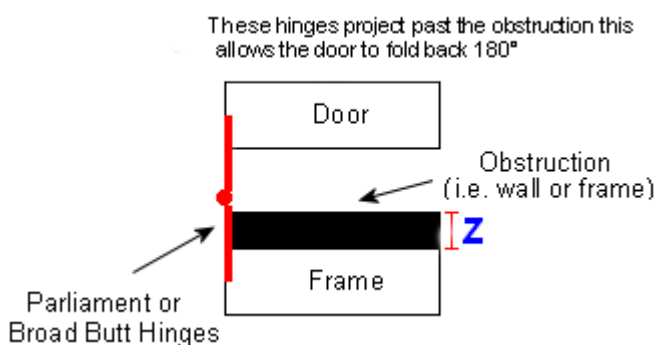
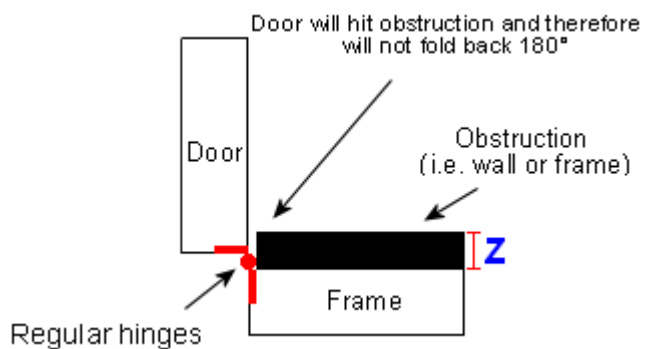

- Suitable for wooden doors
- Stainless steel base material, suitable for internal or external use.
- The grade 13 certification allows the hinges to be used on doors up to 120kg in weight and is up to 1 hour fire resistant
- To meet fire regulations 3 hinges must be fitted per door and intumescent pads must be fitted behind each leaf.

Unit Of Sale

- Hinges are sold and priced in **pairs (2 hinges)** and come supplied with fixing screws.

Products in this set



50542.1 - Ball Bearing Broad Butt Projection Hinges - Grade 13 - Fire Rated - CE / UKCA Marked - Certifire Approved - 120kg Weight Limit - 102mm x 102mm - Matt Antique Brass (Lacquered) - Pair - (2 Hinges)