Easy Fit Flush Hinge - 60mm - Antiqued Bronze

Product Images



Description

- Flush hinges ideal for cabinet and cupboard doors
- Flush fit no need to mortice in to door or carcass

Finish

- Antiqued bronze

Dimensions

- 20705.1 - (60mm x 40mm x 1.2mm)

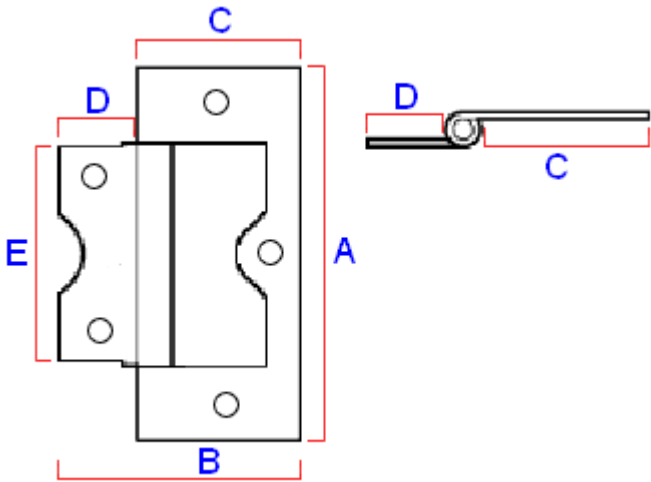

	20705.1	Dimension On Diagram
Height	60mm	A
Overall Width	40mm	B
Leaf Width C	21mm	C
Leaf Width D	14mm	D
Leaf Height E	34mm	D
Thickness	1.2mm	N/A

Important Info Before You Buy

- Our flush door hinges are suitable for wooden doors
- Flush door hinges are only suitable for doors that inset the cabinet carcass - (see below diagram)

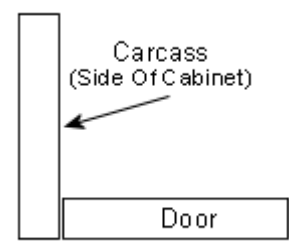

- Base material is steel with a bright zinc plated finish
- Flush hinges are "easy fit" non mortice - No chiselling required just screw straight on to door and carcass
- Leaf "D" folds into leaf "C" to allow the hinge to close together "flush"
- Each - (1 Hinge)

Products in this set



20705.1 - Easy Fit Flush Hinge - 60mm Bronze - Antiqued Bronze - Each