

Flush Fitting Rectangular Ring Pull - Available In Two Sizes - Satin Chrome

Product Images



Description

- Flush fitting, inset handle with pull out ring pull.
- Ideal for use on bi-folding doors, cupboards, kitchen cabinet doors, wardrobes and trapdoors and sliding doors.
- Ring sits flush within the rectangular backplate when not in use. The ring can then be pulled out from the plate to allow you to open your door.
- This item has to be morticed (cut) into the door to allow it to sit fit flush.
- Available in two sizes
- Satin chrome plated - brushed finish.

Size Details

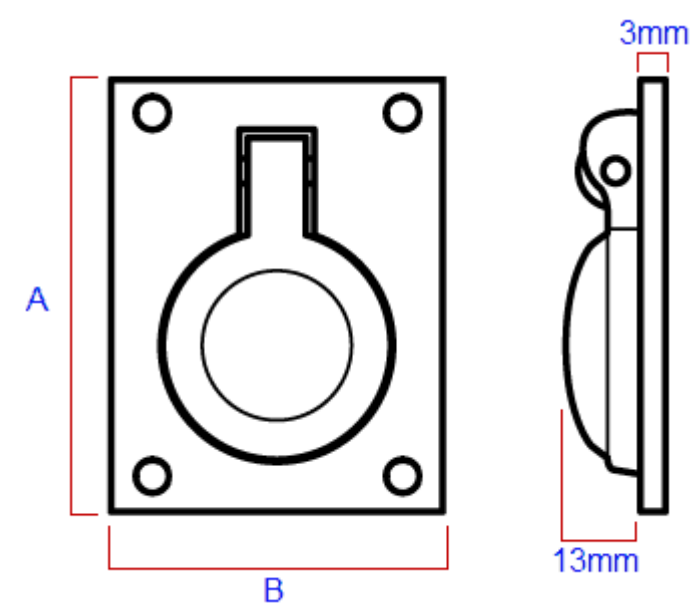

Item Code	Height (A)	Width (B)	Depth	Backplate Thickness
20797.1	50mm	39mm	13mm	3mm
20797.2	64mm	51mm	13mm	3mm

Base Material

- Made from solid brass.

Finish Details

- Satin chrome - A grey colour with blue undertones and visible brush marks in the surface of the item.
- The solid brass base material has been satinised (brushed with a satin wheel) and then chrome plated to produce this finish.
- For more information and how to care for this finish please see our [guide to product finishes](#).

Alternative Finishes Available

- Polished chrome
- Antique brass
- Polished brass

Fixings

- This handle is fitted via 4 x countersunk wood screws through the face of the backplate.
- Matching screws are supplied with this item.

Usage

- Suitable for internal or external use.

[external](#) use.

- To fit this handle completely flush a minimum door thickness of 18mm is required.

Unit Of Sale

- This item is sold individually - (Each)

Products in this set



20797.1 - Flush Fitting Rectangular Ring Pull - Satin Chrome - 50mm x 39mm - Each



20797.2 - Flush Fitting Rectangular Ring Pull - Satin Chrome - 64mm x 51mm - Each