4 Ball Bearing Broad Butt Projection Hinge 102mm x 102mm Polished Brass (Lacquered)

Product Images



Description

- Broad butt projection hinges for double, patio and French doors
- Hinges allow doors to fold back on its self 180 degrees
- Polished brass 4 ball bearing hinges
- Suitable for very heavy internal or external doors

Finish

- Polished brass

Dimensions

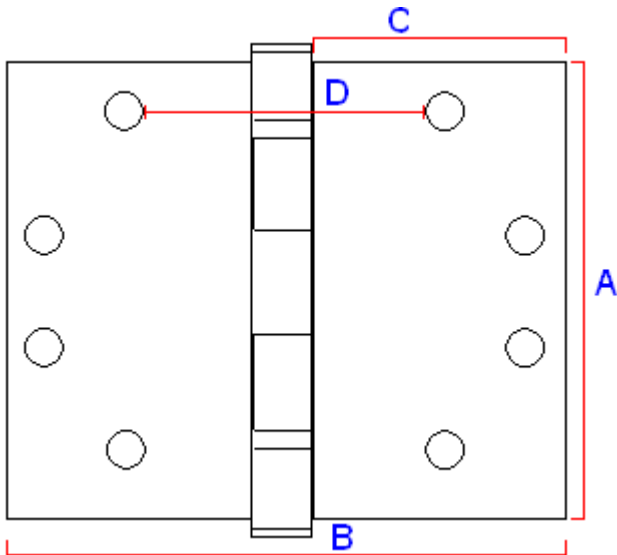

Available in 1 Size only

20946.1- (102mm x 102mm x 3mm)

	20946.1	Dimension On Diagram
Height	102mm	A
Width	102mm	B
Leaf Width	43mm	C
Projection given	50mm	D
Thickness	3mm	N/A

Important Info Before You Buy

- Broad butt projection hinges are used to help project or "throw" a door past an obstruction so it can fold back on it's self 180degrees

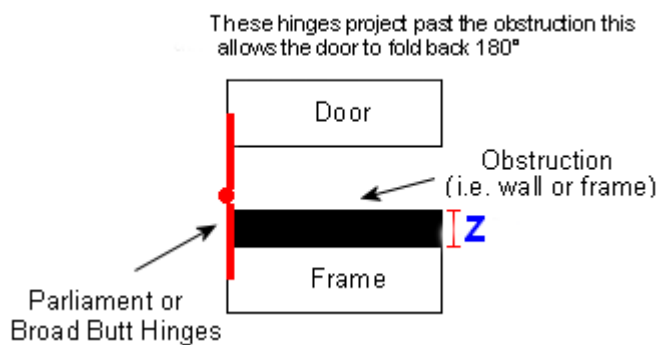
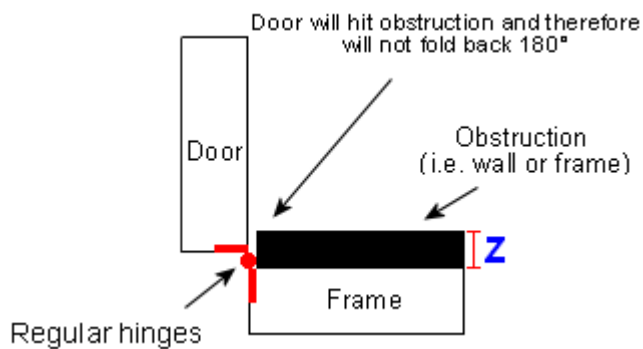

- Suitable for wooden doors
- Base material is brass
- Hinges have 4 ball bearings in the knuckle. This gives the hinge excellent strength / wear-ability on the door and a smooth action
- These hinges have a high quality lacquer coating and are suitable for internal or external use. (Please note the lacquer will break down after time and the brass will tarnish. This will happen a lot quicker on external doors compared to internal doors)
- Hinges are sold and priced in pairs and come supplied with screws

Products in this set



20946.1 - 4 Ball Bearing Broad Butt Projection Hinges - Polished Brass (Lacquered) - 102mm x 102mm - Pair