

---

## T-Bar Shape Guardsman Style Pull Handles - Bolt Through Fixing - Polished Stainless Steel

### Product Images

---



### Description

---

- Guardsman style T-Bar shape stainless steel pull handle
- Shiny polished stainless steel ideal for internal doors and external entrance doors
- Bolt through the door design see below diagram

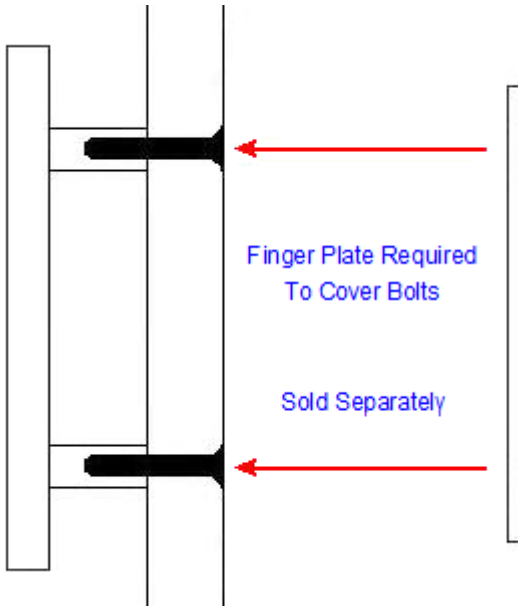

Above diagram shows how a bolt through pull handle is fitted to a wooden door

**Alternative Fixing Options:**

- Bolt through fixing with cover caps (where no finger plate is wanted on the reverse side) - see related product - **43479**
- Back to back pair (kit for fitting pull handles to both sides of the door) - see related product - **43481**

**Finish**

- Polished stainless steel

**Alternative Finishes Available**

- Satin stainless steel

**Dimensions**

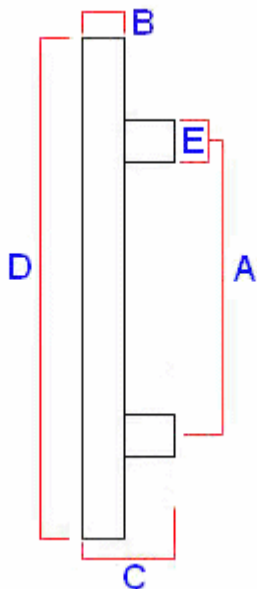

Item	Bolt centers (A)	Diameter (B)	Projection (C)	Overall Length (D)	Post Diameter (E)
31220.1	225mm	19mm	63mm	325mm	16mm
31220.2	300mm	19mm	63mm	400mm	16mm

<b>31220.3</b>	900mm	19mm	63mm	1000mm	16mm
<b>31220.4</b>	300mm	25mm	70mm	400mm	22mm
<b>31220.5</b>	450mm	25mm	70mm	600mm	22mm
<b>31220.6</b>	650mm	25mm	70mm	750mm	22mm
<b>31220.7</b>	900mm	25mm	70mm	1000mm	22mm

**Important Info Before You Buy**

- Suitable for wooden doors
- Pull handles are best suited for areas of high or heavy use such as offices, schools and public buildings
- Sold Individually

## Products in this set

---



31220.1 - T-Bar Pull Handle - Bolt Through - Polished Stainless Steel - 325mm Length (225mm Centres)  
x 19mm Diameter



31220.2 - T-Bar Pull Handle - Bolt Through - Polished Stainless Steel - 400mm Length (300mm Centres)  
x 19mm Diameter



31220.3 - T-Bar Pull Handle - Bolt Through - Polished Stainless Steel - 1000mm Length (900mm Centres)  
x 19mm Diameter



31220.4 - T-Bar Pull Handle - Bolt Through - Polished Stainless Steel - 400mm Length (300mm Centres)  
x 25mm Diameter



31220.5 - T-Bar Pull Handle - Bolt Through - Polished Stainless Steel - 600mm Length (450mm Centres)  
x 25mm Diameter



31220.6 - T-Bar Pull Handle - Bolt Through - Polished Stainless Steel - 750mm Length (650mm Centres)  
x 25mm Diameter



31220.7 - T-Bar Pull Handle - Bolt Through - Polished Stainless Steel - 1000mm Length (900mm Centres)  
x 25mm Diameter